

Set-Up Guide

Smart Door Lock – Yale Touchscreen – YRD220



Thank you for purchasing a smart door lock for use with your Rogers Smart Home Monitoring System. Set-up is easy – just follow the steps outlined in this Set-Up Guide.

Once you've set-up your Smart Door Lock, the lock will allow keyless entry without sacrificing any safety. Its Touchpad makes this an ideal deadbolt for any homeowner looking to add extra security without extra trouble.

With Rogers Smart Home Monitoring you will have remote access to your Smart Door Lock and have peace of mind knowing your home is locked and secure wherever you are.

Package Contents:

- 1 Smart Door Lock
- 2 Manufacturer's installation and programming booklet
- 3 Set-Up Guide – for pairing the lock to your Smart Home Monitoring system

Device Installation

Please refer to the enclosed Yale Real Living Touchscreen Deadbolt installation and programming instructions.

Installation video is available at: rogers.com/installdoorlock

(Please note, in the video, the wireless network module comes pre-installed).

Important Installation Steps:

- 1 Remove existing lock.
- 2 Prepare lock for installation.
- 3 Install lock.
- 4 Create Lock Master Code.

NOTE: Lock Codes are separate from your system codes. Lock Codes cannot arm/disarm the system for security reasons. Only Lock Codes can lock/unlock the door lock.

- * To avoid injury, read all set-up and safety information included in your package before installing and setting up your device.
- * If you encounter a problem setting up your Smart Door Lock, please call Rogers Technical Support at **1 888 764-3771**.



Pair the Lock & the Touchpad



PLEASE INSTALL ONE LOCK AT A TIME

Once the door lock has been physically installed and tested for proper functioning, follow these steps to connect/pair your Smart Door Lock with your Rogers Smart Home Monitoring Touchpad.

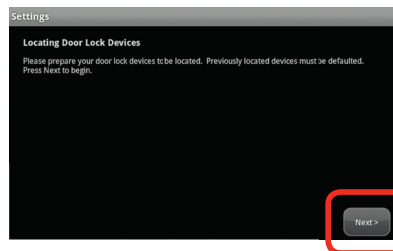
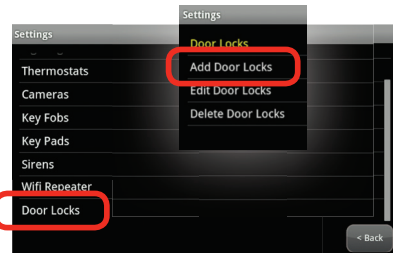
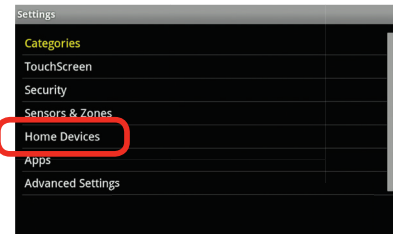
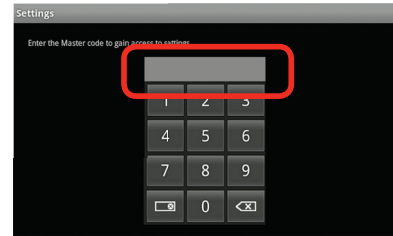
- 1 Ensure system is disarmed.
- 2 On the Touchpad, select the **Settings** app from the Home Screen.
- 3 Enter your Master Access Code (4-digit code). Your Master Access Code is the same code that you use to manage your system.
- 4 Select **Home Devices** under the Categories list.
- 5 Scroll down and select **Door Locks**, then select **Add a Door Lock**.
- 6 On the Locating Door Lock Devices screen press **Next**, and the system will take up to 30 seconds to find the lock.



Pairing the Smart Door Lock & the Touchpad

- 7 On the Door Lock, activate the touchscreen by touching the screen completely with your hand (this wakes the lock).
- 8 Enter the Door Lock's Master Code followed by # key to enter Menu Mode.
- 9 Press 7 followed by # key to enter the Pairing Menu.
- 10 Press 1 followed by the # key to begin pairing Door Lock. The Door Lock will announce "Completed".
- 11 On the SHM Touchpad, a "Pairing" icon:  will appear and change to a "Door Lock" icon:  Door Lock once pairing is complete. Please note this may take 2 to 5 minutes.
- 12 Click **Done** once the Door Lock icon appears, and hit **Next** to confirm.
- 13 The Door Lock icon will appear again. Tap on the icon to customize its name (i.e. Front Door).
- 14 Click **Return to Menu** to complete the pairing of the Smart Door Lock.

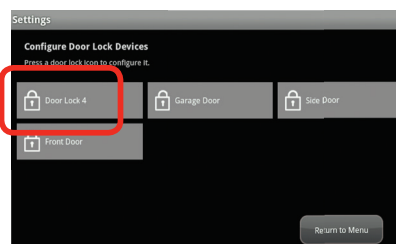
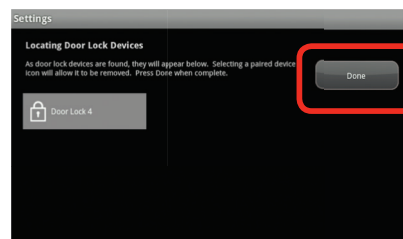

Congratulations!

Your Smart Door Lock is now part of your Smart Home Monitoring system. You will now be able to remotely control the Smart Door Lock with your touchpad, your smartphone app and through the Web Control Centre.





Using the Smart Door Lock

Unlock/Lock Door with The Mobile App

- 1 On the Mobile App Home screen, tap on Door Locks icon



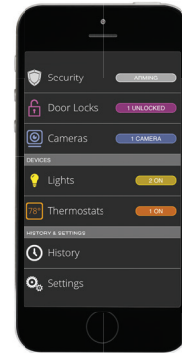

- 2 Select the desired Door Lock to control
- 3 On the Door Locks screen:

- To Unlock: tap on the locked icon 
- To Lock: tap on the unlocked icon 





Unlock/Lock Door with The Touchpad

- 1 On the Touchpad Home screen, tap on Door Locks icon 
- 2 On the Door Locks screen:

- To Unlock: tap on the locked icon 
- To Lock: tap on the unlocked icon 



Unlock/Lock Door with The Web Control Centre

- On the Web Control Centre Home page or Manage Door Lock page:
 - To Unlock: tap on the locked icon 
 - To Lock: tap on the unlocked icon 

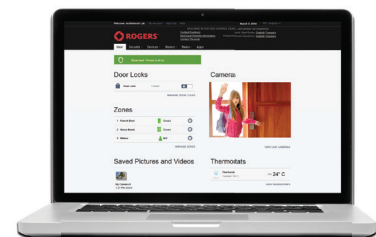

Unlock/Lock Door with The Lock

- To Unlock: cover the screen with your hand to awaken the lock, then enter your 4-digit code followed by *.
- To Lock: cover the screen with your hand.



Status Indicators



Low battery warning



All Code Lockout mode

(All user code access restricted except master code)

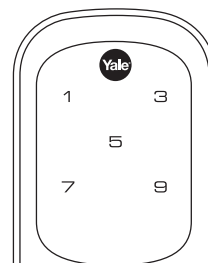

Door Lock Error

- Incorrect user code
- Door lock jam



Smart Door Lock Features

Automate your lock using "Rules" on the Web Control Centre at smarthome.rogers.com.

Notifications

- Receive instant notifications through email or text when your Smart Door Lock is being tampered with or being unlocked.

Rule Creation

- Set-up rules such as automatically locking all your Smart Door Locks when arming your system.
- Rules are not impacted by changing the name of the door lock, as they follow the serial number of the door lock.

**SMART HOME
MONITORING**

9055-SHM-YDLK-EN-0615